

Request drawing

Please enter desired dimensions in fields:

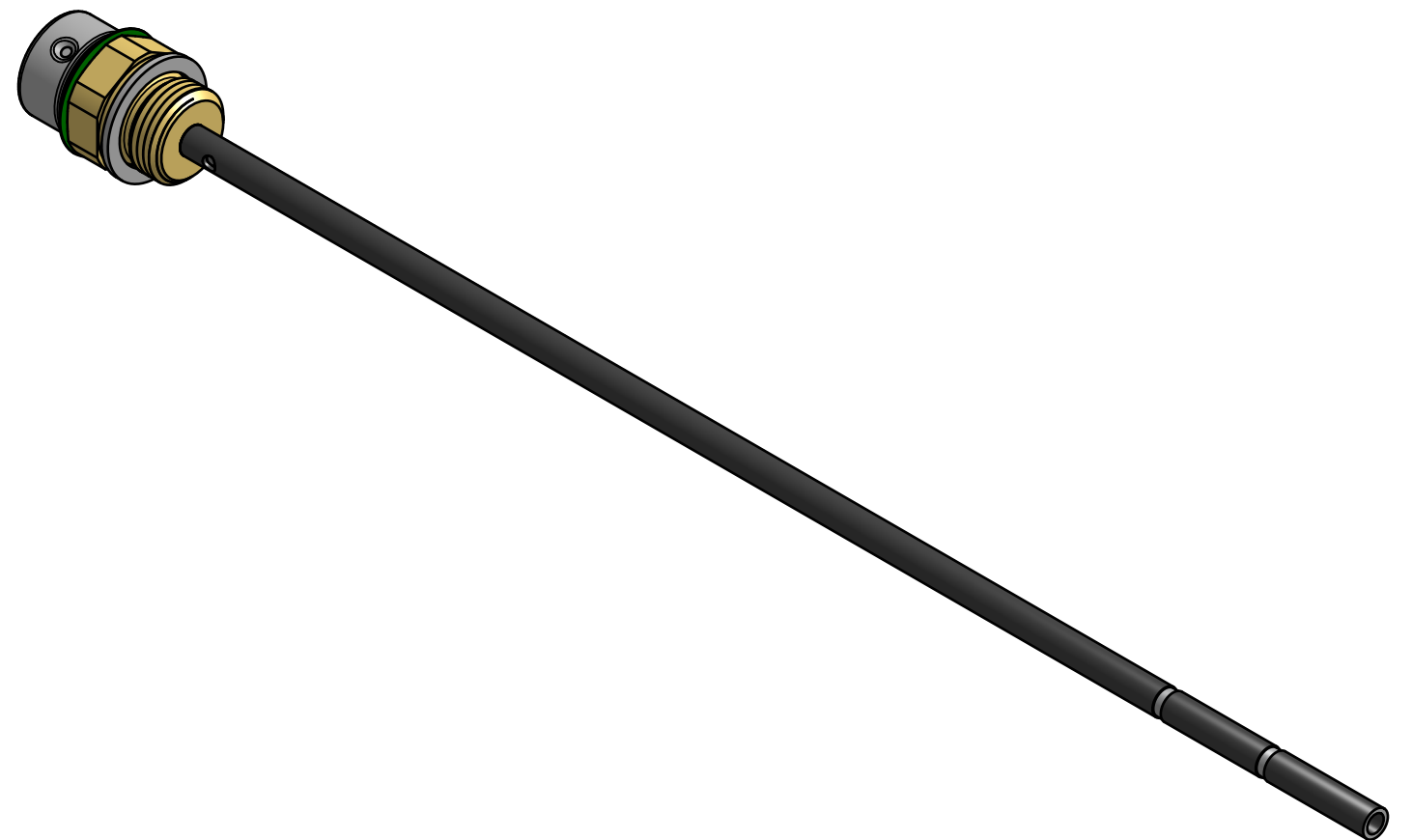

Opening pressure =

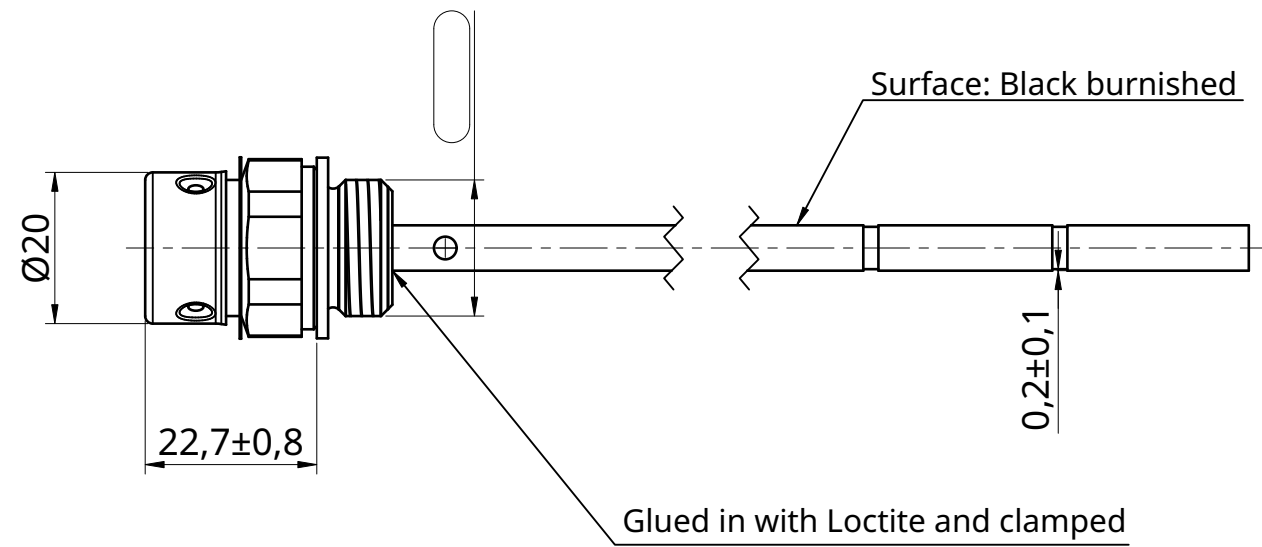
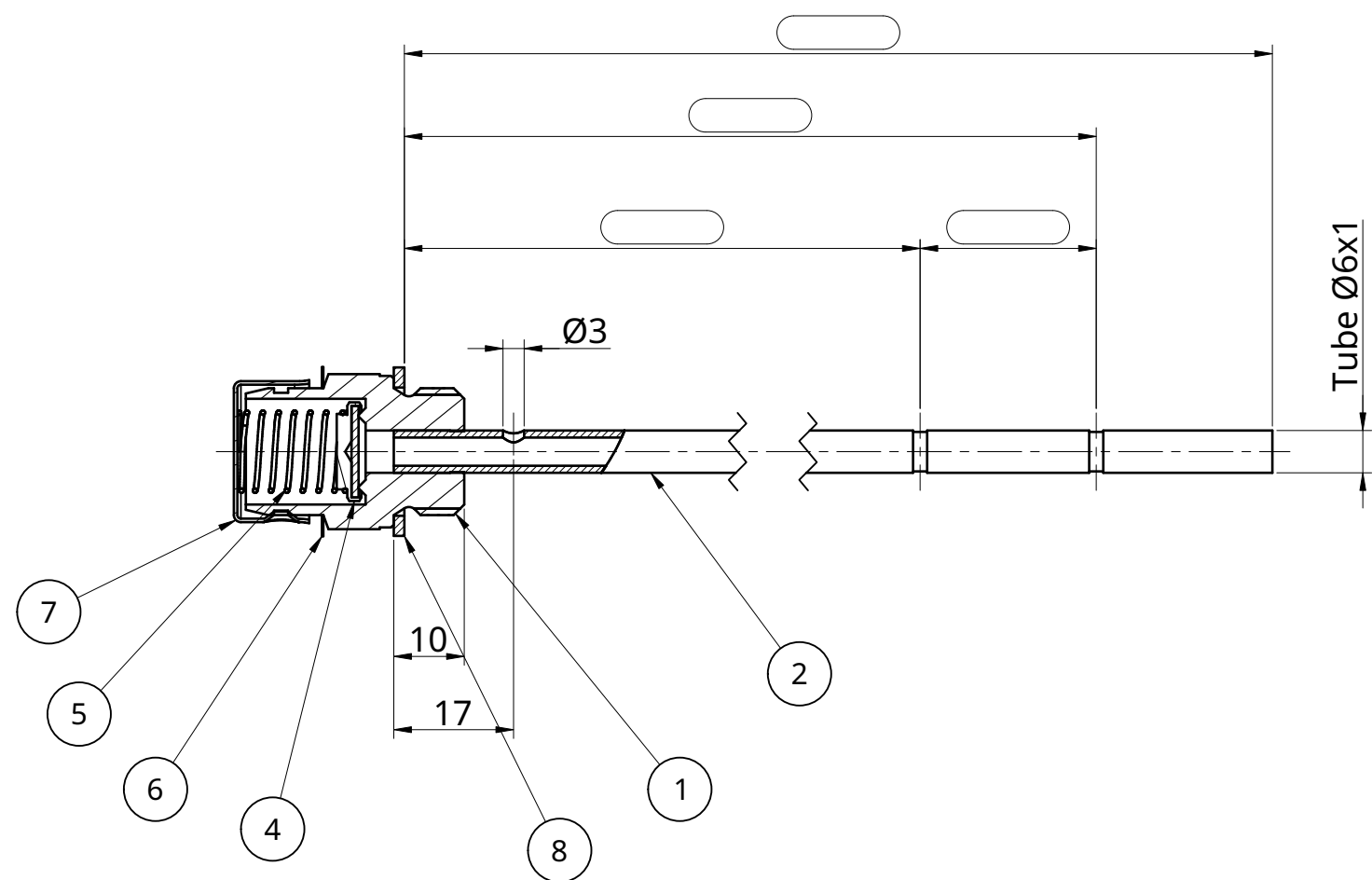

Pos. / Item	Anz. / Qty.	Description	Material	Surface
1	1	Body EV+BE	2.0401 CuZn39Pb3	bare
2	1	Measuring rod tube	E235+N	burnished black
3	2	loctite Art.-Nr. 19150	Loctite 2701	green
4	1	valve plate 14mm with sealing disc	Separate BOM	Separate BOM
5	1	compression spring EV-02	1.4310 X10CrNi18-8	bare
6	1	identification ring green 18,2 x 24 x 0,2	PVC green	green (02)
7	1	ventilation cap EV+BE 1.4301	1.4301 X5CrNi10-10 A2	bare
8	1	VA 1.4571 Sealing ring DIN 7603 - A	1.4571 X6CrNiMoTi17-12-2 A4	bare

		Mass: 0.0000 kg	Scale: 1:1	Pos:	Quantity:
		State: CAD $\pm 10\%$	Separate BOM	Separate BOM	Separate BOM
Dimensions without tolerance indication DIN ISO 2768-mk	Date	Name	Oil measurement tube with air vent valve 02		
Maße ISO 14405-1 / Size ISO 14405-1	Drawn 02.03.2023	Glanzner			
Surfaces, series 2 by DIN ISO 1302	Checked 02.03.2023	Schmitt			
Edges by DIN ISO 13715	Norm				
Copyright protection! We reserve all rights for this technical file.		Skarke GmbH		1 / 1	
		Auf der Rut 4 / 64668 Rimbach-Mitlechtern		A3	
		Phone: 06253/8062-0 Fax: 06253/8062-22			
				(State of the drawing: IN PROGRESS)	